

DOUBLE DOOR AND FRAME

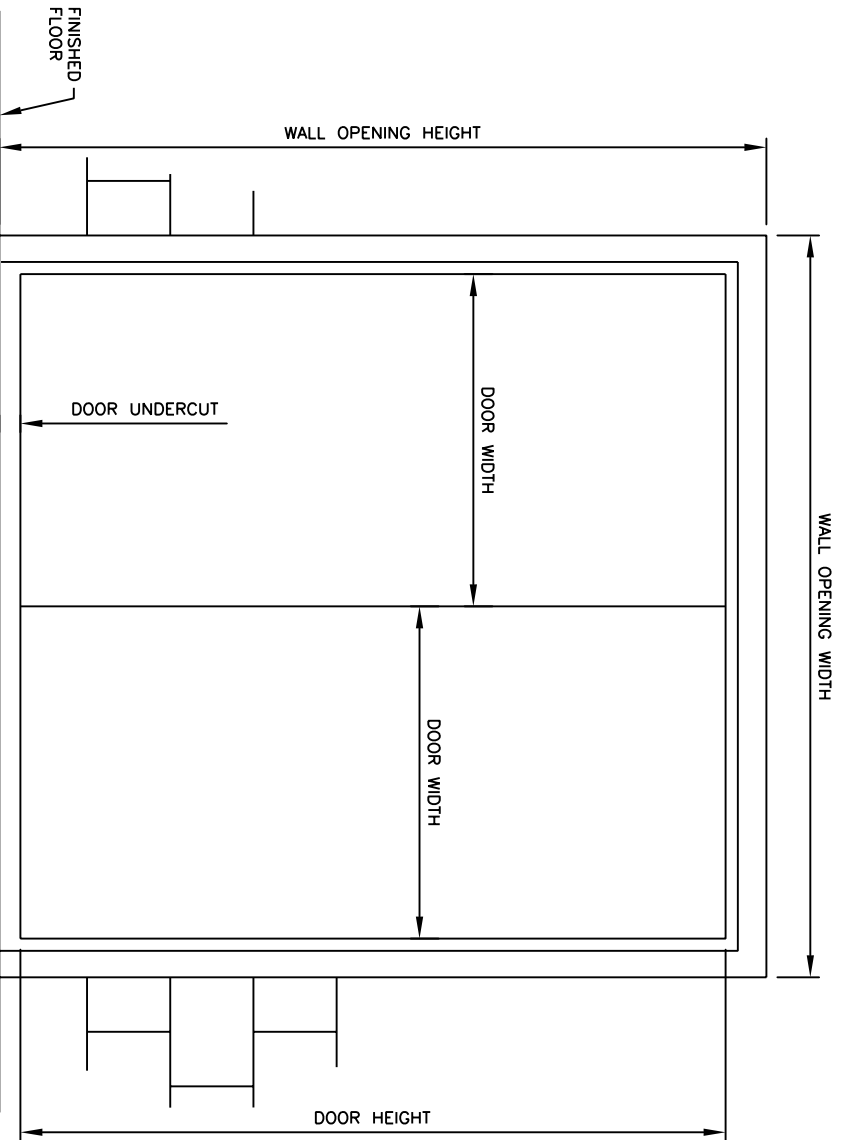

"ROUGH OPENING" CONSTRUCTED FRAME *

WALL OPENING WIDTH X WALL OPENING HEIGHT FRAME WIDTH X FRAME HEIGHT

ACTIVE DOOR WIDTH (IF WIDTHS DIFFER) INACTIVE DOOR WIDTH (IF WIDTHS DIFFER)

ANCHOR TYPE (BS, BM, G) DOOR TYPE (F, VG, ETC.) HAND OF DOOR DOOR UNDERCUT

* CONSTRUCTED FRAME WILL BE UNDERSIZED BY 1/2" IN WIDTH AND 1/4" IN HEIGHT FROM ROUGH OPENING DIMENSIONS TO ALLOW FOR FRAME SHIMS.

SPECIFICATIONS

1-3/4" THICK 2" THICK

COLOR: GRAY TAN OTHER: _____

ASTRAGAL: FRP ASTRAGAL OTHER: _____

GLAZING:

1/4" TEMPERED GLASS 5/8" INSULATED GLASS

1/4" WIREGLASS 1/4" LUCITE SAR

OTHER: _____

HARDWARE FURNISHED BY: TIGER DOOR OTHERS

SEE ATTACHED HARDWARE SCHEDULE WHERE APPLICABLE

COMMENTS: _____

MACHINE FOR:

HARDWARE PREP

4-1/2" MORTISE HINGES 5" MORTISE HINGES

CYLINDRICAL TYPE 161 LOCK RIM DEADBOLT

MORTISE TYPE 86 LOCK OR EXIT DEVICE (EDGE CUTOUT ONLY)

FLUSH BOLTS (INACTIVE LEAF OF DBL. DOOR)

OTHER: _____

REINFORCE FOR:

CLOSER, PARALLEL ARM RIM PANIC EXIT DEVICE

CLOSER, TOP JAMB OVERHEAD HOLDER/STOP

CLOSER, REGULAR ARM PUSH/PULL PLATES

OTHER: _____



FIELD INFORMATION FORM
DOUBLE DOOR AND FRAME

DOOR MARK:

OWNER: